

# Holidaysflat Residence Paracurù villa Colonial 75 € 43.000



Relax

**HOLIDAYSFLAT**

**Houses in Residence**  
**Casas em Condominio Fechado**  
**Paracurù Fortaleza Brasil**



aperitivos

The House proposal is in a Condominium with 15,000 square meters of green area – Where: entering Paracuru in avenida principal on the right side just before the petrol station PETROBRAS only 5 minutes from downtown and beautiful beaches of the city. Paracuru-Fortaleza Bus every hour stop at the door. Assistance for airport transfers, rental cars and bikes

Casas em Condominio fechado – 15.000 metros de area verde entrando em Paracuruna avenida principal 300 metros antes do Posto Petrobras – A cinco minutos do centro e das praias bonitas. Onibus Fortaleza/Paracuru a cada hora Parada facultativa na porta. Informamos para transfer Aeroporto e aluguel de carros e motos

Case in condominio Custodito con 15.000 m. di area verde DOVE: entrando in Paracurù nella via principale 300 metri prima del distributore Petrobras – Bus fortaleza Paracurù: ogni ora, con Fermata facultativa alla porta. Assistenza per transfer Aeroporto e noleggio di auto e moto



Barbeque



Forno Pizza Social

Furnished Houses For Rent & Sales  
Aluguel e Venda de Casas

Negotiations with owners <> Diretamente com proprietarios



Piscina

**Contact Info and reservations:**  
***paracurukite@gmail.com***

Holidaysflat Residence Paracurù villa Colonial 75 € 43.000



Colonial 75



Holidaysflat Residence Paracurù villa Colonial 75 € 43.000



sala /cozinha



Sala

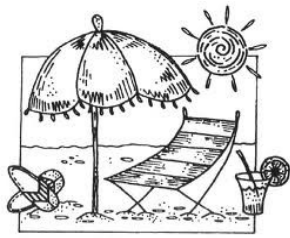

banheiro



# Holidaysflat Residence Paracurù villa Colonial 75 € 43.000

consegna 120 gg dall'ordine



quarto 1



quarto 2



quarto 1

quarto 2



**Villetta Colonial 75 mq.**  
Sala-Soggiorno con angolo cottura  
2 camere letto con armadi a muro  
1 Bagno 1 dispensa  
Veranda con 2 giardini  
Lavatoio e 1 doccia esterna  
costo finito € 43.000  
di cui  
€ 12.000 il lotto urbanizzato  
€ 31.000 la costruzione



# Holidaysflat Residence Paracurù villa Colonial 75 € 43.000

## Holidaysflat Residence

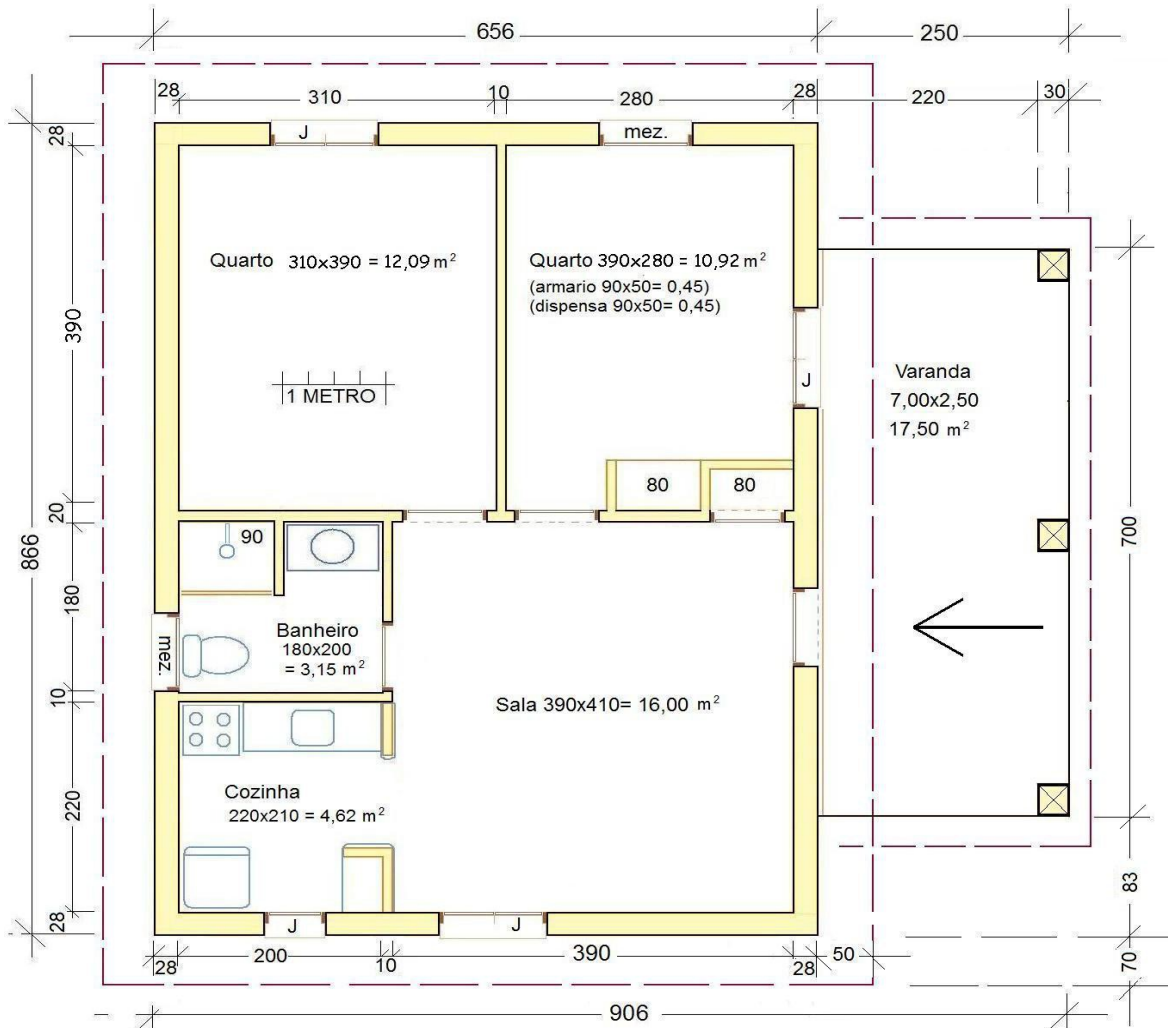

PLANTA BAIXA RESIDENCIA FAMILIAR	
proprietario	
Area Lote	15,00 x 9,80 = 147,00 m <sup>2</sup>
Perimetro Lote	= 35,44 ml
Perimetro Casa	35,44 ml
Area Casa	8,66x6,56 = 56,80 m <sup>2</sup>
Area Varanda	6,00x2,50 = 17,50 m <sup>2</sup>
Area Construida	Total 74,30 m <sup>2</sup>

### Paracuru Praia Pedra Rachada

